

Recessed luminaire - Micro-prismatic diffuser - direct distribution

Sheet steel housing suitable for ceilings with visible T-rails, concealed symmetrical rail constructions and recessed ceilings; Housing colour traffic white RAL 9016; Direct light distribution using microprismatic pane made of PMMA, a soft light shines through frosted diffusers; neutral white light colour (840) with very good colour consistency and high colour rendering  $R_a > 80$  for VDU workstations,  $65^\circ < 3000 \text{ cd/m}^2$  with omnidirectional glare suppression according to current DIN-EN 12464-1 standard.; Electrical connection via 3-pole connection terminal with plug-in contacts.; With changeover converter for emergency lighting operation on request. TNE-BM mounting mechanism 6 pcs. 1200/1250 for concealed symmetrical rail constructions or recessed ceilings, please order separately.

## CHARACTERISTICS

Order number	50806114170
EAN number	4020863355709
Commodity code	94051190
Certification mark	IP 20, Protection class I, VDU $65^\circ < 3000$ , F, F-"roof" mark, Indoor, CE
Impact resistance (IK rating)	IK02
Ambient temperatur	ta 25°C
Warranty period	5 years
State funding programs	BEG - Federal funding for efficient buildings (valid only for Germany)

## ELECTRICAL ENGINEERING

Controller	Electronic driver (1 pcs.)
System output	58W
Mains voltage	230V/50Hz
Circuit breakers (inrush current)	15 pieces/B10, 24 pieces/B16, 25 pieces/C10, 40 pieces/C16
Energy efficiency class/light source	C

## LIGHTING TECHNOLOGY

Placement	LED, Colour rendering/Light colour CRI $\geq 80$ / 4000K
Colour tolerance (MacAdam)	3SDCM
Photobiological safety (Luminaire)	RG0
Nominal luminous flux	7737lm
LED service life	50000h L80/B10 (Tq 25°C)
Luminaire luminous efficiency	134lm/W
UGR lat./long.	18.4 / 18.7

## MECHANICS

Housing colour	traffic white RAL 9016
Dimensions (LxWxH/DxH)	1247mm x 622mm x 102mm
Depth	100mm
Ceiling system	Ceilings with visible T-rails [s-TS] (625x1250 mm), Concealed symmetrical rail construction [VS] (625x1250 mm), cut-out ceilings [AD]
Ceiling cut-out (LxW/D)	585mm x 1191mm
Installation depth	120mm [AD]; 250mm [s-TS]; 150mm [VS]
Weight (net)	10.4kg
Type of installation	Recessed mounting, Ceiling installation individual mounting

## DEEP-LINK

<https://www.regiolux.de/en/article/50806114170>

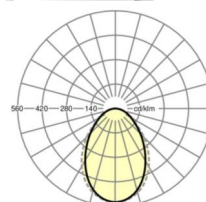

Reference	LED 7300lm 840
$\eta_{LB}$	100 %
$\Phi_{\downarrow/\uparrow}$	100 % / 0 %
UGR lat./long.	18.4 / 18.7
VDU	$65^\circ < 3000 \text{ cd/m}^2$

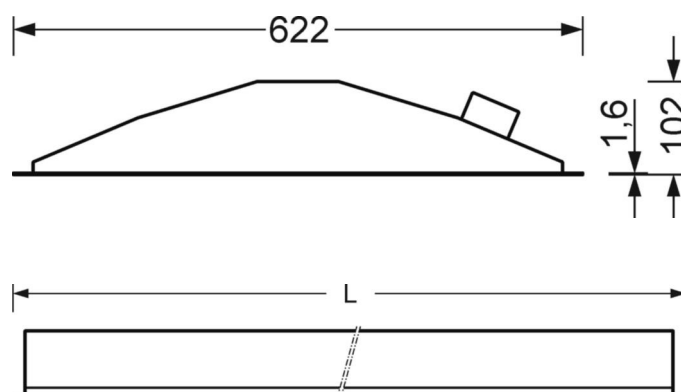

## Dimensions

---

<b>L</b>	1247 mm	Length
<b>B</b>	622 mm	Width
<b>H</b>	102 mm	Height
<b>T</b>	100 mm	Depth
<b>DA(L)</b>	585 mm	Cutting dimension length
<b>DA(B)</b>	1191 mm	Cutting dimension width
<b>Et(AD)</b>	120 mm	Ceiling distance minimum (cut-out ceiling)
<b>Et(TS)</b>	250 mm	Ceiling distance minimum - recommended (visible T-rail)
<b>Et(VS)</b>	150 mm	Ceiling distance minimum (concealed symmetrical)
<b>MLTS1</b>	1250 mm	Module dimension length (visible T-rail)
<b>MLTS_1/2</b>	1250	Module dimension length (visible T-rail) 1/2
<b>MLVS</b>	1250 mm	Module dimension length (concealed symmetrical)
<b>MBTS1</b>	625 mm	Module dimension width (visible T-rail)
<b>MBTS_1/2</b>	625	Module dimension width (visible T-rail) 1/2
<b>MBVS</b>	625 mm	Module dimension width (concealed symmetrical)

---